



MV110 User Manual V1.0

Learn how to set up your new MiCODUS Tracker

1. Main Features



GPS+LBS+AGPS



Remotely Cut Off /Resume Fuel



Historical Route Playback



Realtime Tracking



12-36V Wide Working Voltage



Storage Memory



Engine Start/ Flameout Alarm



Power Disconnect Alarm



Geo-fence



Overspeed Alarm



Tow Alarm



Lifetime Free Tracking Platform

2.Specifications

Device Information	Model	MV110	
	Weight	42g	
	Dimensions	90mm(L) * 45mm(W) * 16mm(H)	
Working Parameters	Network	2G GSM/GPRS	
	Band	850/900/1800/1900Mhz	
	GPS sensitivity	-159dBm	
	GPS accuracy	<5m (under open sky with good GPS signal)	
	Work voltage	12-36V DC	
	Working Humidity	10%-85%RH non-condensing	
	Time To First Fix	Cold status	45s
		Warm status	35s
		Hot status	1s
	Storage Temperature	-40°C to +85°C	
Operation Temperature	-20°C to +55°C		
Humidity	5%–95% non-condensing		

3.Product Structure

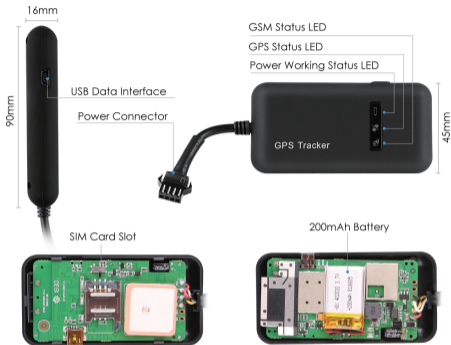

NOTE ⚠️⚠️⚠️ :

- 1.The USB interface just can be used for firmware updating, can't be used for charging
- 2.The 200mAh battery version is optional, please make sure you ordered the correct version

4.How to manage the tracker to get online?

Step 1



Please get a suitable SIM card from your local place. The SIM card must meet below points:

- ◆ It must be compatible with the 2G GSM network
- ◆ Please enable SMS, call, internet data traffic of the SIM card
- ◆ Enable the caller ID display feature
- ◆ Remove the PIN code
- ◆ Use Normal size SIM card for the tracker
- ◆ Please inquire the SIM card provider for the exact correct APN information

Step 2 Insert the SIM card

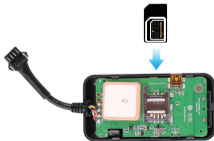

Step 3 Wiring Diagram

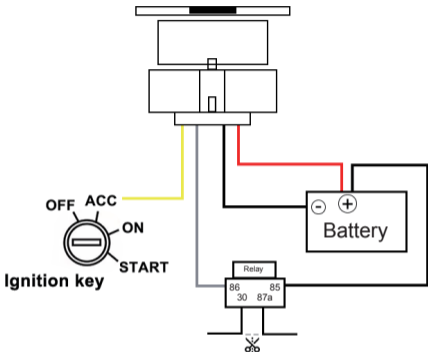

Device has 2PIN and 4PIN, only 4PIN version has ACC function

- 1) Red wire connect power positive +
- 2) Black wire connect power negative -
- 3) Yellow wire connects to ACC ignition line positive +
- 4) White wire connects to relay white wire

Step 4 Configure APN

Please get the exact correct APN name from local SIM card provider. Take the tracker to a good signal place for operation and configure the APN for it as below:

INSTRUCTION	COMMAND	REPLY
Turn on GPRS	GPRS123456	GPRS OK
APN (any existing will be replaced) APN username (If without, please ignore) APN password (If without, please ignore)	APN123456+space+APNname +space+APNuser name+ space+ APNpassword	APN OK

Note: The APN information is very important, it must 100% correct to match with the sim card of the tracker, if you configured wrong APN, the tracker also will reply "SET APN ok" but it will can't get online!

Step 5 Indicator status description

LED	Event	State
Green Light (GSM)	GSM signal connection	Solid
	searching GSM signal	Flash every 1 second
Blue Light (GPS)	GPS signal connection	Solid
	Searching GPS signal	Flash every 1 second
Red Light (Power)	Power ok	Solid

NOTE :

* Please connect tracker with 12-36V DC external battery for the power supply.

* All led indicators will turn off after 10 minutes for hidden. You can call the SIM number of the tracker to wake up it!

5. Package Content

GPS Main Unit	x 1
Function Cable	x 1
Relay(Optional)	x 1
User Guide	x 1
Genuine Packing Box	x 1

6. Functions Explanation

a.APN without user and password:

Take China Mobile SIM card as example,their APN name is "cmnet",no user and no password, then the sms command should be sent as below:

b.APN with user and password:



Take the tesco mobile SIM card in UK as example, the APN information of it is as below:

APN name: prepay.tesco-mobile.com

APN username: tescowap

APN password: password

Then the APN sms commands should be sent as below:

NOTE    : Different operators have different APN information, please make sure the APN is exact correct!

For example:



For example:



7. Installation Recommendation

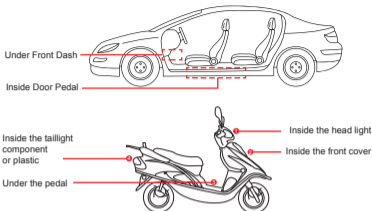

- 1) The device should face up to the sky.
- 2) Metal thermal barrier of heating layer of the windshield affects the signal.

8. Troubleshooting

Type	Use
Unable to connect to tracking platform	Check the APN and settings. Check whether the data service of SIM card is enabled. Check the balance of SIM card.
Tracker shows offline	Check whether external power is still connected. Check if the vehicle entered network blind area. Check the balance of SIM card.
Unable to locate	Make sure the top side facing upward without metallic things shielded. Make sure it's not in area with no satellite coverage.
Location drift	In area with poor GNSS signal (tall building around or basement), drifting may happen.
No command reply	Make sure command format is correct. Vehicle may be in network blind area. Make sure SIM card is well inserted and has SMS service.

9. Full SMS Commands List

Command Name	Command Format	Explanation
Set APN	apn123456 apn Name	apn123456 cmnet
	apn123456 apn name user password	apn123456 cmnet cmwap 66666
Set IP / DNS port	adminip123456 IP port	adminip123456 47.254.77.28 7700
	adminip123456 DNS port	adminip123456 d.micodus.net 7700
Parameter	check123456	check device's status
Reset to Factory Default Settings	begin123456 or reset123456	
Check Position	smslink123456	Tracker will reply with Latitude, Longitude, Google Maps URL
Setup Admin Number	admin123456 mobile number	admin123456 008613810008888
Cancel Admin Number	noadmin123456 mobile number	noadmin123456 008613810008888
Setup Full Time zone	time zone123456 full time zone	time zone123456 1 or time zone123456 -1 (1 means east 1,-1 means west 1)
Setup Half Time zone	time zone123456 half time zone	time zone123456 8 30 (8 30 means east 8.5 time zone)
Setup Movement Alarm	move123456	
Cancel Movement Alarm	nomove123456	
Over-speed Alarm	speed123456 speed limit value	speed123456 80 (80 means 80km/h, it is configurable)
Cancel Speed Alarm	nospeed123456	
Cancel Low Battery Alarm	lowbattery123456 off	
Engine On/Off Alarm	acc123456	
Cancel On/Off Alarm	noacc123456	
Cut Off Fuel	cut123456	The fuel will be cut off completely when the speed is less than 20KM/H
	stop123456	Stop car quickly
Resume Fuel	resume123456	
Data Upload Interval (default 10s)	fix030s***n123456	This means every 30seconds/1 time positioning, the time interval is changeable

10. Any Questions?

E-mail: support@micodus.com

Skype: MiCODUS

11. Download the APP

Search "MiCODUS" in iOS APP store or Google Play Store, or just scan the QR code as below to download MiCODUS APP:

